

GENERAL NOTES:

1. ALL DIMENSIONS AND LEVELS TO BE VERIFIED ON SITE PRIOR TO COMMENCEMENT OF THE WORKS. ANY DISCREPANCIES TO BE REPORTED TO THE ENGINEER.
2. THIS DRAWING IS TO BE READ IN CONJUNCTION WITH THE RELEVANT ARCHITECT'S AND OTHER ENGINEERING DRAWINGS.

LEGEND

- EXISTING WATERMAIN
- PROPOSED WATERMAIN 100mmØ (PE80)
- 25mm Ø SERVICE CONNECTION FROM BOUNDARY BOX
- PROPOSED STORM SEWER & MH
- Ⓜ PROPOSED STOPCOCK AND WATER METER BOUNDARY BOX
- Ⓜ PROPOSED FIRE HYDRANT
- Ⓜ PROPOSED SLUICE VALVE
- Ⓜ EXISTING SLUICE VALVE
- Ⓜ PROPOSED MARKER POST & INDICATOR PLATE
- Ⓜ PROPOSED THRUST BLOCK
- Ⓜ PROPOSED AIR VALVE

WATERMAIN NOTES:

1. ALL WATERMANS AND SUPPLY SHOULD BE CONSTRUCTED TO IRISH WATER REQUIREMENTS AND IN ACCORDANCE WITH IRISH WATER CONNECTIONS & DEVELOPER SERVICES WATER INFRASTRUCTURE STANDARD DETAILS IW-CDS-5020-03 JULY 2020.
2. THE CONTRACTOR SHOULD CONFIRM THE LOCATIONS OF ALL EXISTING WATERMAIN INFRASTRUCTURE ON SITE AND REPORT TO THE ENGINEER.
3. WATERMAIN PIPES SHOULD HAVE A MINIMUM NOMINAL PRESSURE CLASSIFICATION OF 10 BAR. MOPVC PRESSURE PIPES SHALL CONFORM TO UK WATER INDUSTRY SPECIFICATION NO 4-31-08 OR EQUIVALENT. MANUFACTURERS SHALL OPERATE A QUALITY SYSTEM IN COMPLIANCE WITH BS 5750 PART 2 (EN29002).
4. WATERMAIN PIPES SHOULD HAVE A MINIMUM COVER OF 900mm
5. AN APPROVED MARKER TAPE CONTAINING A TRACER WIRE SHOULD BE AFFIXED TO THE TOP SURFACE OF ALL WATERMANS
6. CONCRETE THRUST BLOCKS SHOULD BE PROVIDED ON WATERMANS AT DEAD ENDS, TEES, BENDS OF CURVATURE GREATER THAN 11.25° AND AT BOTH SIDES OF A SLUICE VALVE CHAMBER. ANCHOR BLOCKS SHOULD ENCASE THE PIPE IN CONCRETE (CLASS E, CLAUSE 1502, SPECIFICATION FOR ROADWORKS) TO A MINIMUM THICKNESS OF 150mm ALL ROUND AND SHOULD BE A MINIMUM LENGTH OF 750mm
7. SLUICE VALVES SHOULD COMPLY WITH THE REQUIREMENTS OF BS 5163. THE DEPTH OF THE SLUICE VALVE SPINDLE CAP BELOW FINISHED GROUND LEVEL SHOULD NOT EXCEED 300mm
8. HYDRANTS SHOULD BE OF THE MALE THREAD SCREW DOWN TYPE IN COMPLIANCE WITH THE REQUIREMENTS OF BS 750. HYDRANT OUTLETS SHOULD COMPLY WITH THE CHIEF FIRE OFFICERS REQUIREMENTS. THE DEPTH OF THE HYDRANT OUTLET BELOW FINISHED GROUND LEVEL SHOULD NOT EXCEED 200mm
9. SCOUR VALVES TO BE LOCATED AT LOW POINTS AND AIR VALVES AT HIGH POINTS ALONG THE VERTICAL PROFILE OF THE WATERMAIN. CONTRACTOR TO AGREE SPECIFICATION FOR VALVES WITH WESTMEATH COUNTY COUNCIL.
10. CONTRACTOR TO ALLOW FOR ROAD OPENING UP LICENCE FOR WORKS IN PUBLIC ROAD, WHERE NECESSARY.

B	08.11.23	UPDATED WITH LATEST SITE LAYOUT	FM	MK
A	06.11.23	UPDATED AS PER WMCC COMMENTS	FM	MK
REV	DATE	DESCRIPTION	BY	APPR

DRAWING STATUS: **TENDER**

CLIENT: **WESTMEATH COUNTY COUNCIL**

JOB DESCRIPTION: **CONSTRUCTION OF 12 HOUSES AT BUNDAIRE, KINNEGAD PHASE IV**

DRAWING TITLE: **INDICATIVE WATERMAIN LAYOUT**

PROJECT No.:	DRAWING No.:
P-3744	C-03
	REV. No.:
	B

SCALE:	SHEET:	DATE:
1:250	A1	26.10.23
DRAWN BY:	CHECKED BY:	APPROVED BY:
PHCG	AK	PHCA

McMahon Associates
 Consulting Civil & Structural Engineers, Traffic Engineers
 PSDP/CDM Principal Designer, Project Managers
 Armagh Drogheda Croydon
 (028) 3752 2940 (0141) 2137050 (0208) 2636051
 e: info@mcmahonengineers.com

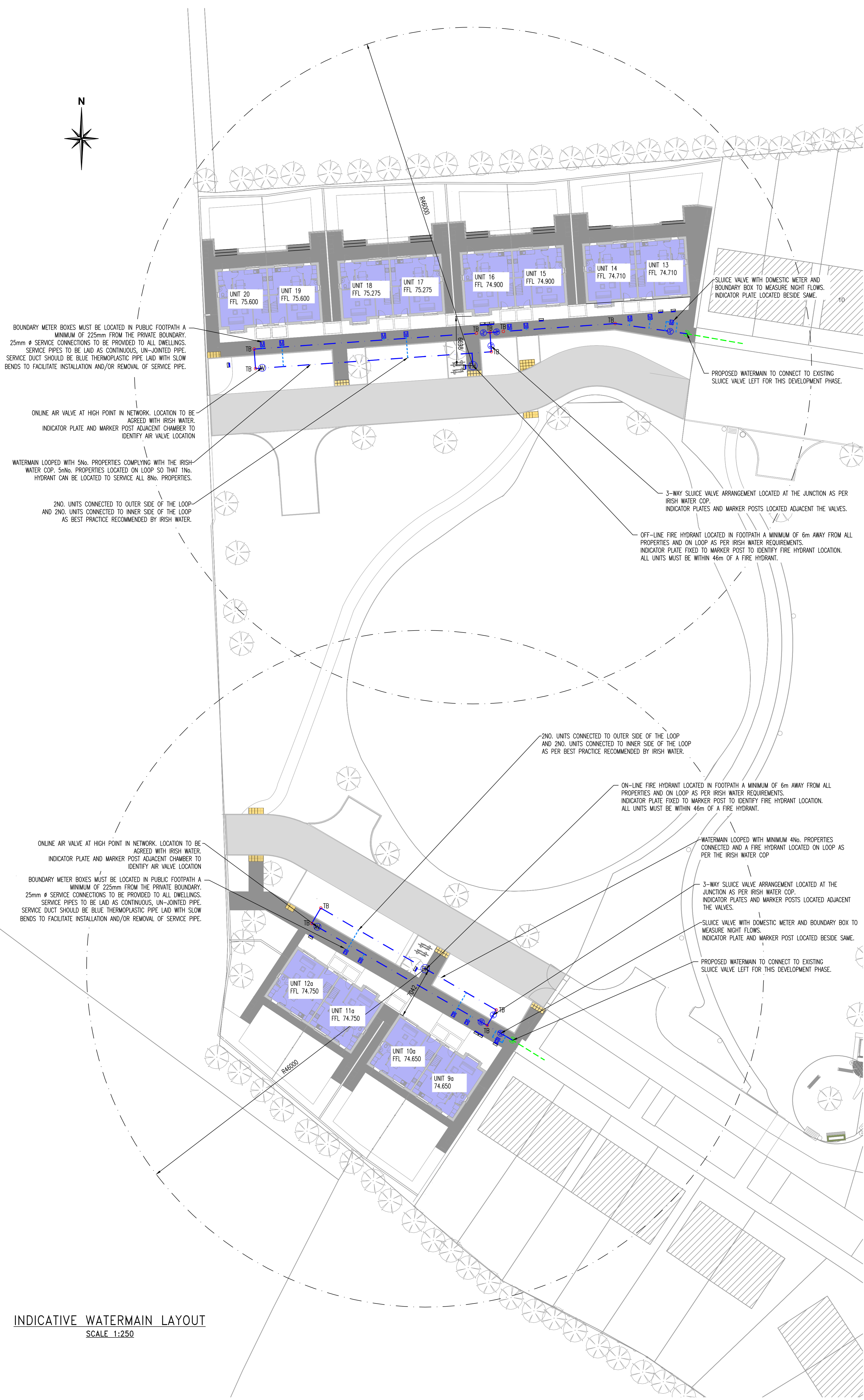
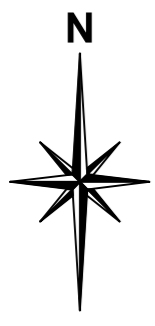

INDICATIVE WATERMAIN LAYOUT
 SCALE 1:250