

**GENERAL NOTES:**

1. ALL DIMENSIONS AND LEVELS TO BE VERIFIED ON SITE PRIOR TO COMMENCEMENT OF THE WORKS. ANY DISCREPANCIES TO BE REPORTED TO THE ENGINEER.
2. THIS DRAWING IS TO BE READ IN CONJUNCTION WITH THE RELEVANT ARCHITECT'S AND OTHER ENGINEERING DRAWINGS.

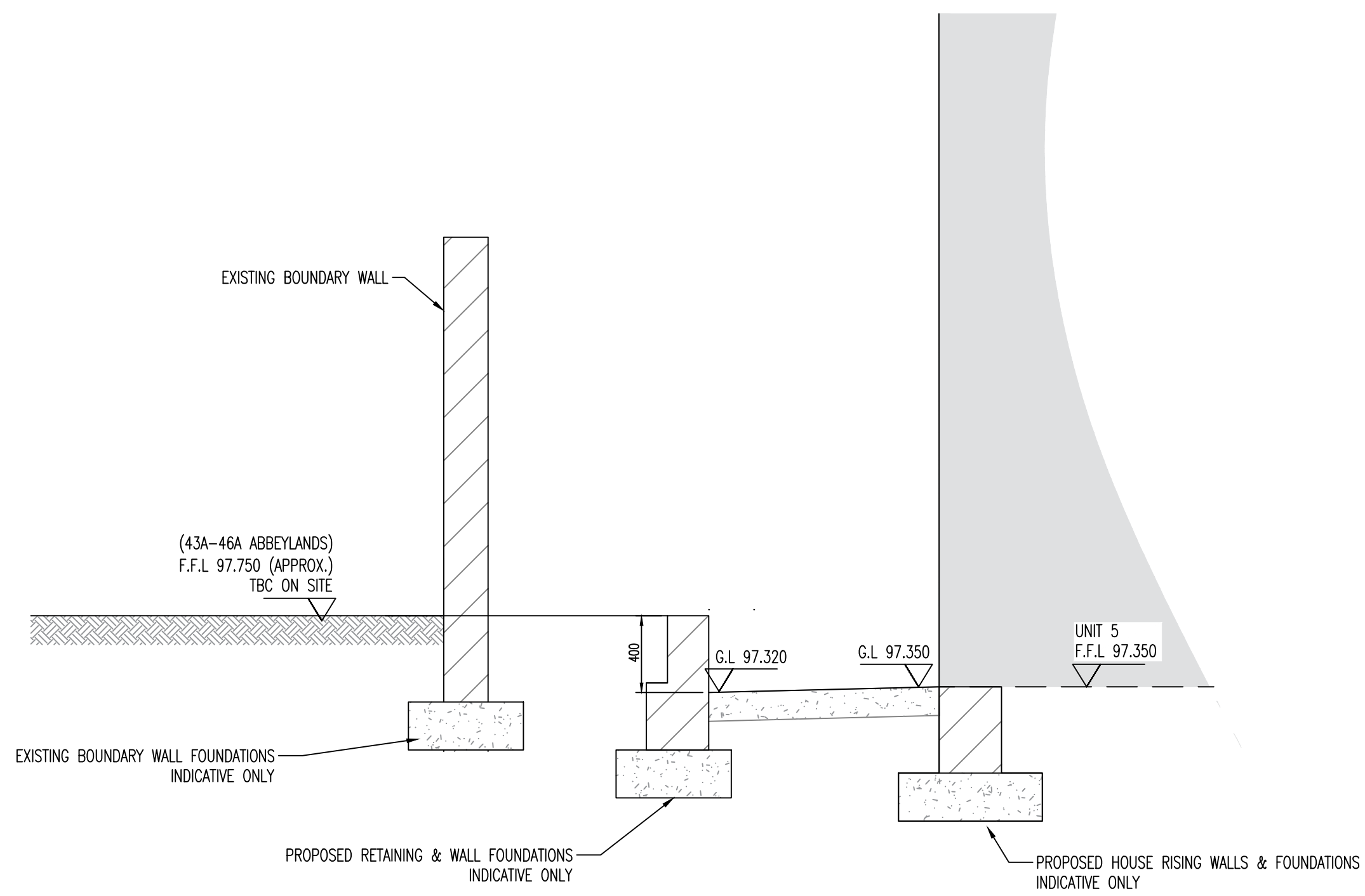

**SECTION A-A (PROPOSED)**  
SCALE 1:25

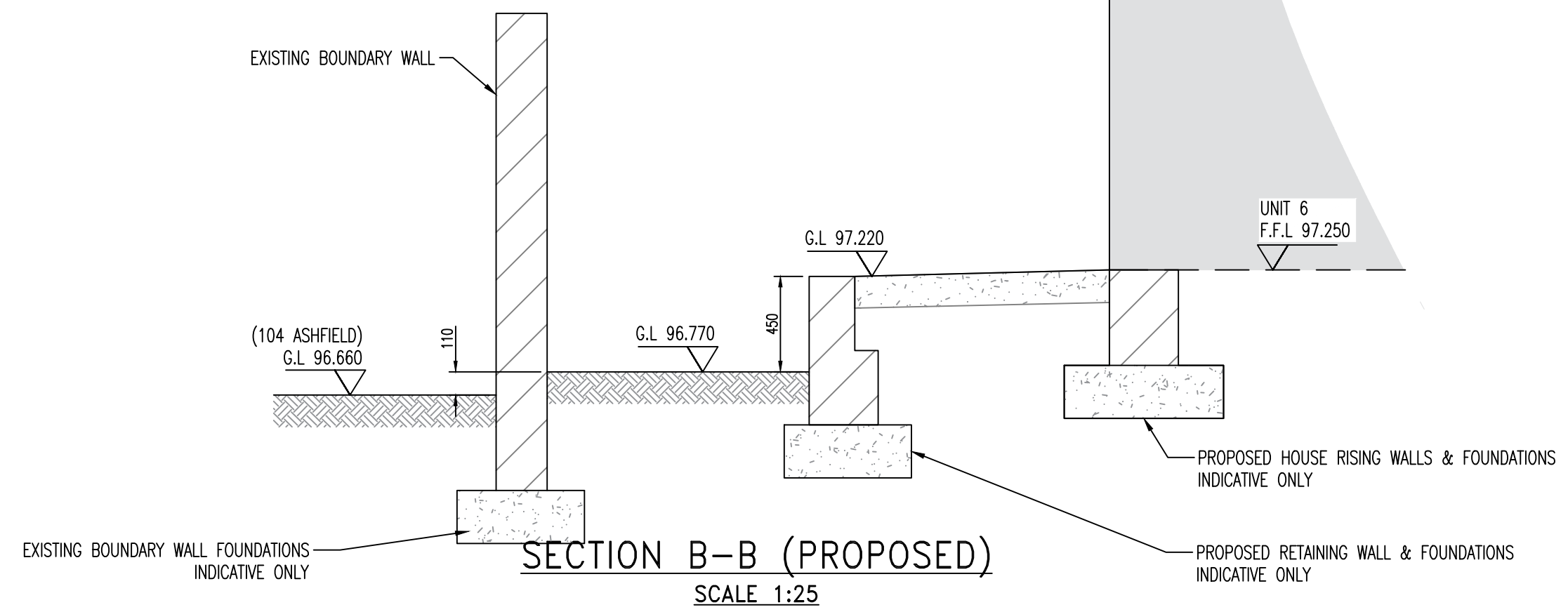

**SECTION B-B (PROPOSED)**  
SCALE 1:25

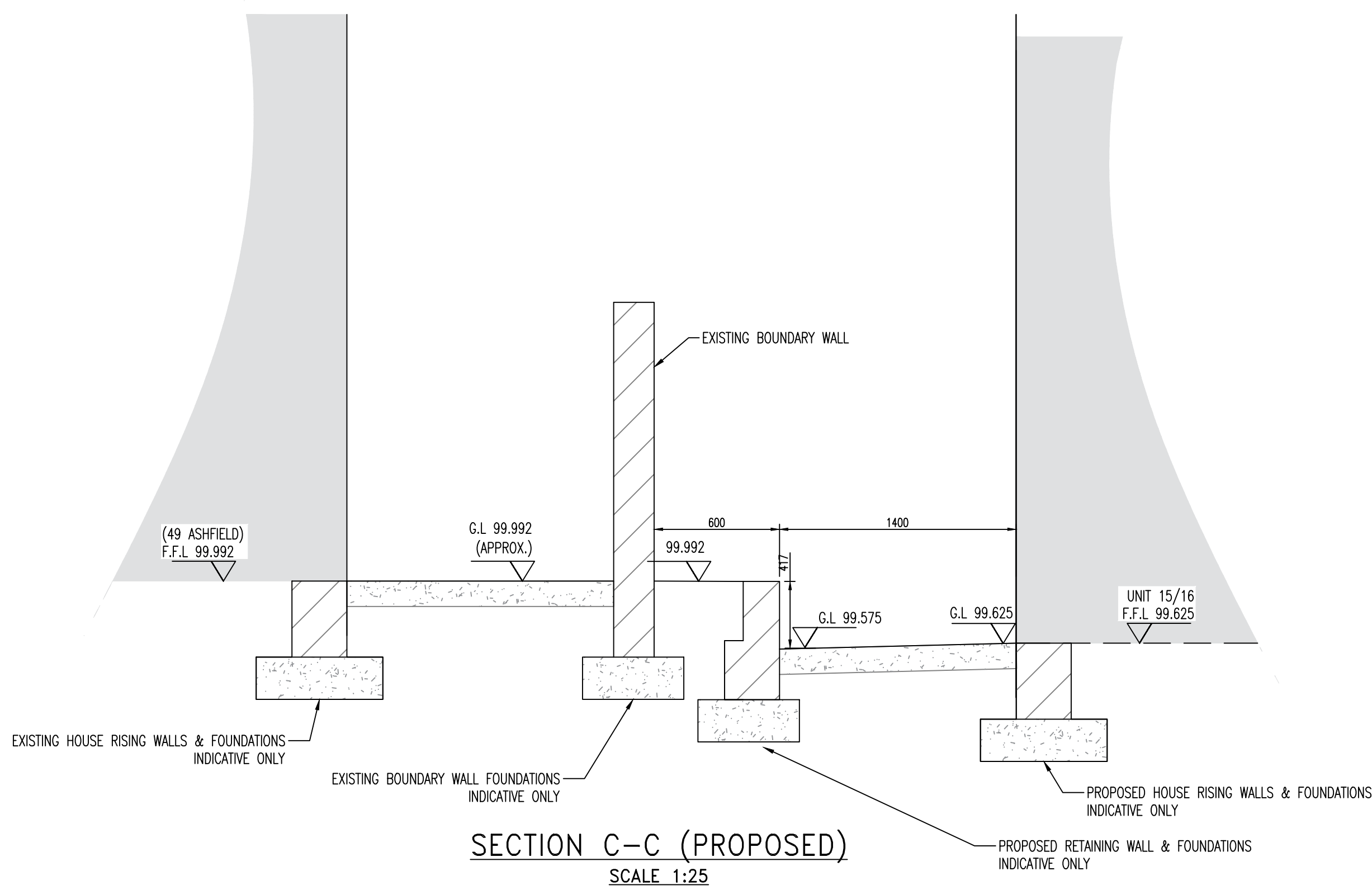

**SECTION C-C (PROPOSED)**  
SCALE 1:25

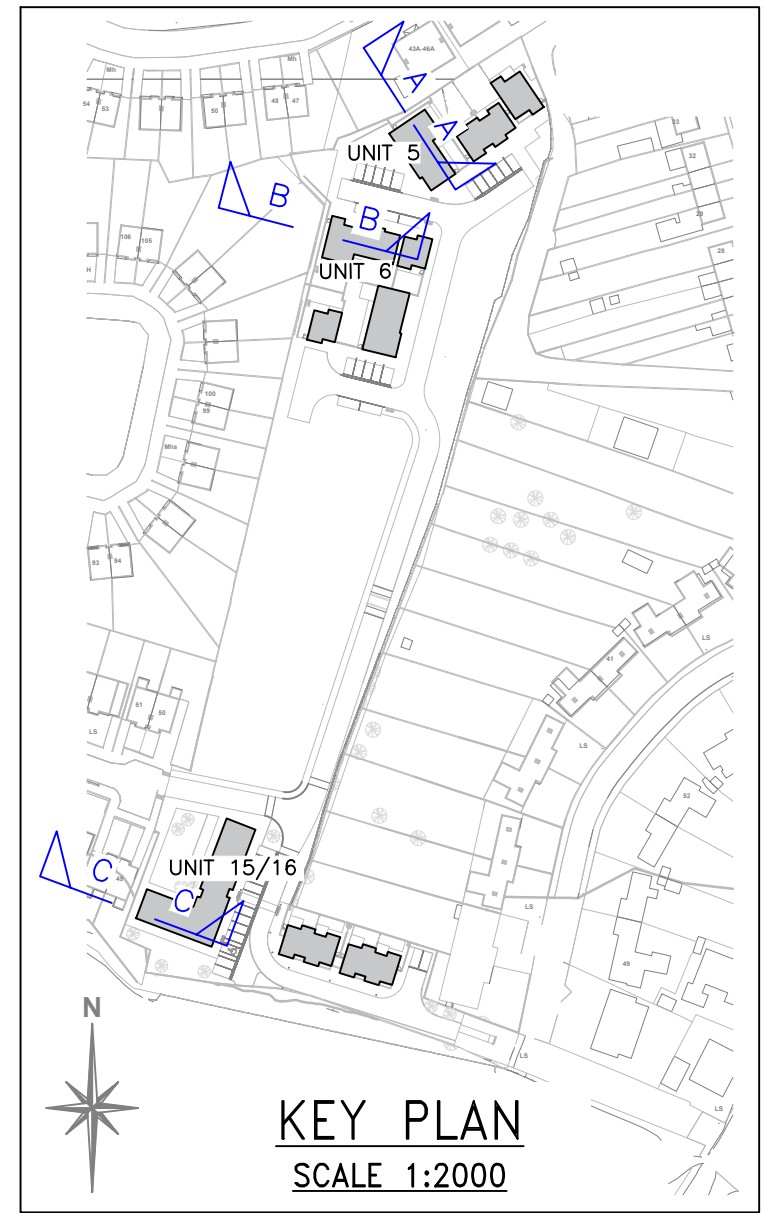

**KEY PLAN**  
SCALE 1:2000

REV	DATE	DESCRIPTION	BY	APPR

DRAWING STATUS: <b>STAGE_2A</b>	
CLIENT: WESTMEATH COUNTY COUNCIL	
JOB DESCRIPTION: PROPOSED 22No. HD AT O'GROWNEY TERRACE, MULLINGAR, CO. WESTMEATH	
DRAWING TITLE: <b>SITE BOUNDARY SECTIONS</b>	
PROJECT No.: <b>P-3457</b>	DRAWING No.: <b>C-311</b>
SCALE: AS SHOWN	DATE: 19.04.21
DRAWN BY: WD	CHECKED BY: MK
APPROVED BY: PMCM	
<p><b>McMahon Associates</b> Consulting Civil &amp; Structural Engineers, Project Managers Environmental Engineers, PSDP &amp; Traffic Engineers The Mill Building, Newtown Link Road, Greenhills, Drogheda, Co. Louth t: 041 2137 050 e: info@mcMahonengineers.com</p>	