

Notes:

This Drawing is to be read in conjunction with the relevant Floor Plans, Particular Specification.

Refer to Particular & General Specification for Full Specification. Particular Specification takes precedence over General Specification.

Do not scale drawings. Use figured dimensions only.

All dimensions should be surveyed by the Contractor before construction.

Capital Housing Team Architect to be informed of any discrepancies before work proceeds.

All work is to be carried out in compliance with the following:

- The current Building Regulations as issued by the Department of the Environment including all latest updates as issued.
- Compliance with conditions of Planning.
- Recommendations for Site Development Works for Housing Areas DOECLG 1998.
- BS 8000: 2011- Works on Building Sites.
- Guidelines for opening, backfilling and reinstatement of trenches in public roads - DOECLG 2002
- All works to comply with E.T.C.I. Regulations.

All level shown are indicative only. Please refer to Engineers drawings for proposed levels.

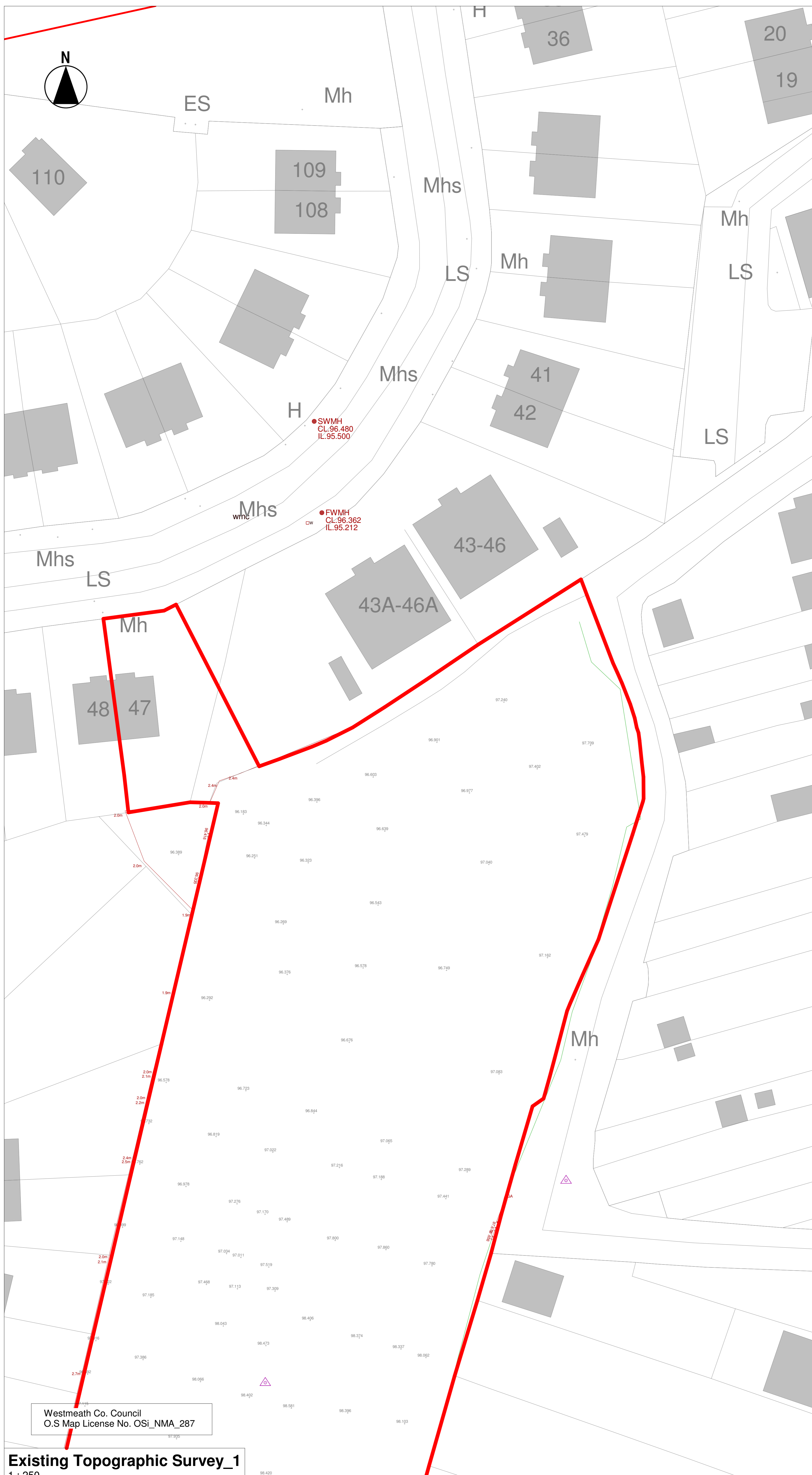

DRAWING TO BE READ IN CONJUNCTION WITH DRAWING 111_02_003

LEGEND

SITE EXTENTS SHOWN OUTLINED IN RED

**PART 8 - PLANNING
NOT FOR CONSTRUCTION**

Revision Schedule

Rev No.	Rev Description	Rev Date	Issued by	Issued to



Funded by the Irish Government under Rebuilding Ireland, Action Plan for Housing and Homelessness.



WESTMEATH HOUSING DESIGN TEAM
WESTMEATH COUNTY COUNCIL,
CIVIC CENTRE, CHURCH ST,
ATHLONE, N37 P2T5
Phone: 09054 42100
Web: www.westmeathcoco.ie

PROJECT:
CONSTRUCTION OF 22 DWELLING UNITS AT ST. BRIGIDS GREEN, MULLINGAR, CO. WESTMEATH

TITLE:
EXISTING TOPOGRAPHIC SURVEY SHEET 1 OF 2

Scale: As indicated **Datum:** MALIN **Date:** 17/05/22
@ A1

Drawing No: 111_03_002 **Stage:** PART 8 **Revision:**

Surveved	Drawn	Checked	Approved
MK	AC/MK	BC/TOH	PH

File Name and Directory:
H:\CAPITAL HOUSING DESIGN TEAM\1 Capital Schemes\111-O'Growney Terrace\Drawings\Part 8\Sheet111_03_002_Site Layout_PART 8_FINAL.rvt

Westmeath Co. Council
O.S Map License No. OSI_NMA_287

Existing Topographic Survey_1
1 : 250