

1 Ex Topo Survey_Sites 1 & 2
1 : 250

© Ordnance Survey Ireland/Government of Ireland 2021/OSi_NMA_287

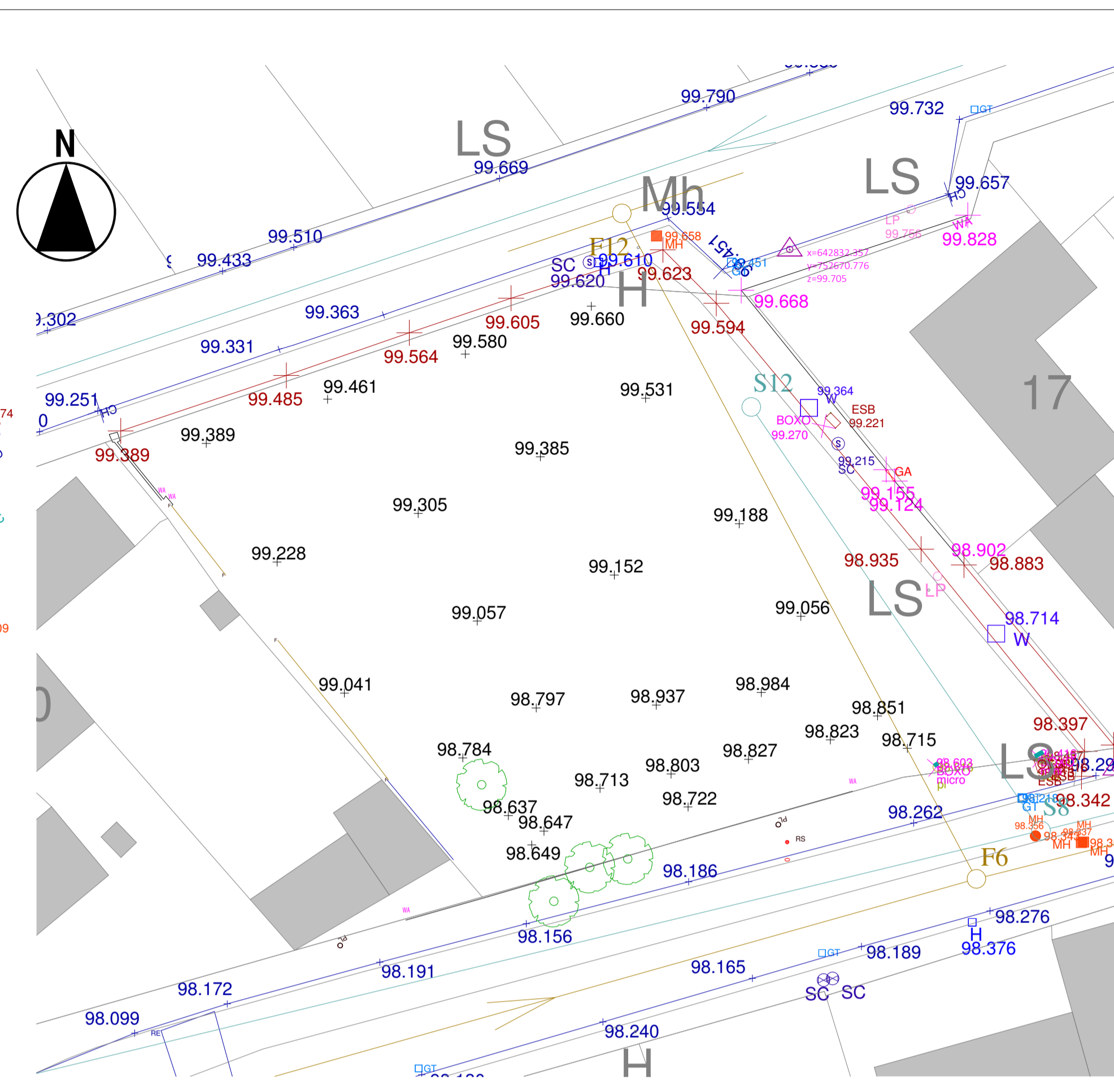

2 Ex Topo Survey_Site 3
1 : 250

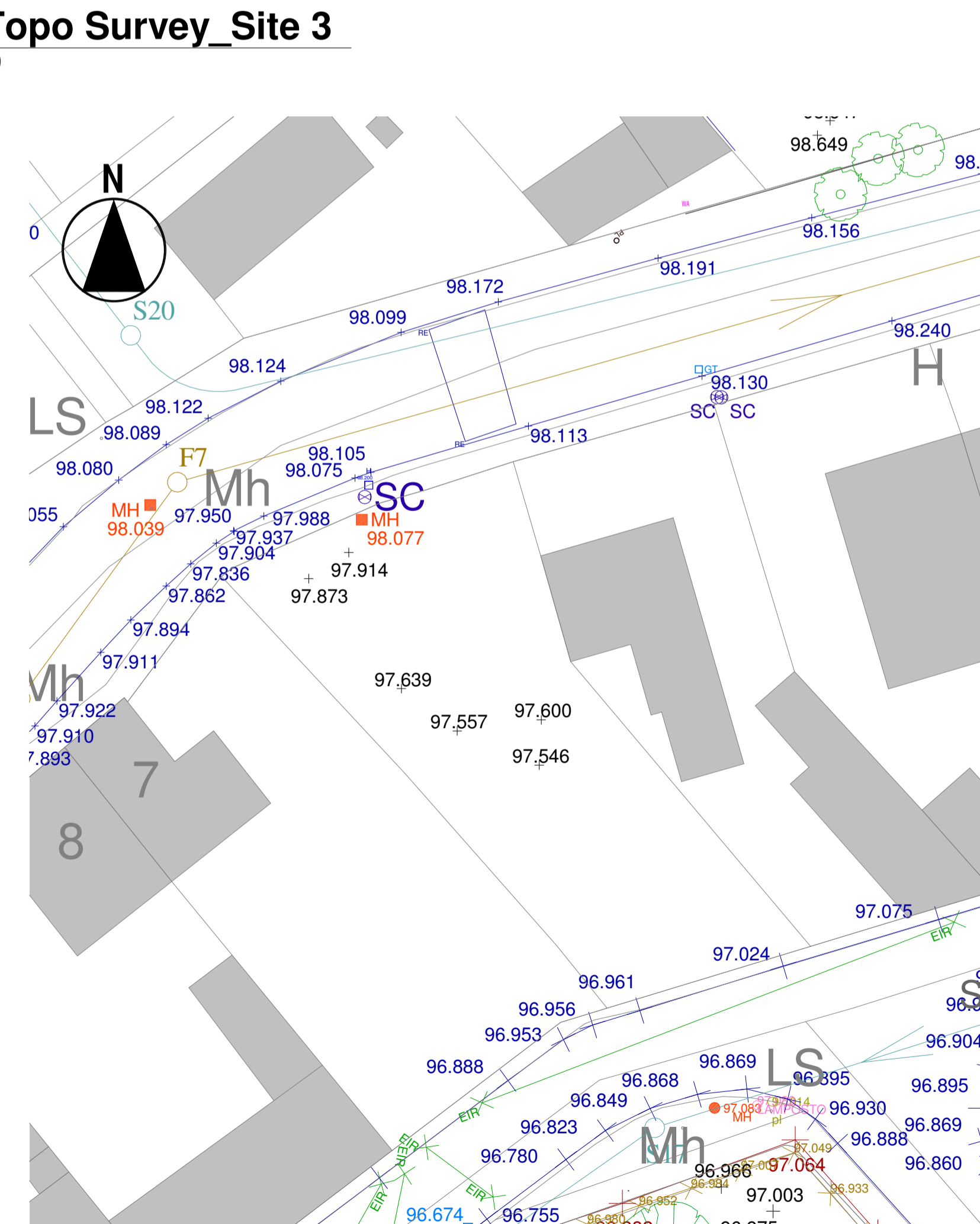

3 Ex Topo Survey_Site 4
1 : 250

Notes:
 This Drawing is to be read in conjunction with the relevant Floor Plans, Particular Specification.
 Refer to Particular & General Specification for Full Specification. Particular Specification takes precedence over General Specification.
 Do not scale drawings. Use figured dimensions only.
 All dimensions should be surveyed by the Contractor before construction.
 Capital Housing Team Architect to be informed of any discrepancies before work proceeds.
 All work is to be carried out in compliance with the following:
 • The current Building Regulations as issued by the Department of the Environment including all latest updates as issued.
 • Compliance with conditions of Planning.
 • Recommendations for Site Development Works for Housing Areas DOECLG 1998.
 • BS 8000: 2011 - Works on Building Sites.
 • Guidelines for opening, backfilling and reinstatement of trenches in public roads - DOECLG 2002.
 • All works to comply with E.T.C.I. Regulations.
All level shown are indicative only. Please refer to Engineers drawings for proposed levels.

PART 8 CONSULTATION
NOT FOR CONSTRUCTION

Revision Schedule

Rev No.	Rev Description	Rev Date	Issued by	Issued to

Funded by the Irish Government under Rebuilding Ireland, Action Plan for Housing and Homelessness.



PROJECT:
 PHASE 2 CONSTRUCTION OF DWELLING UNITS AT ENNELL COURT, MULLINGAR, CO. WESTMEATH

TITLE:
 EXISTING TOPOGRAPHICAL SURVEY

Scale: 1 : 250 @ A1	Datum: MALIN	Date: 01/04/22
Drawing No: 115_03_002	Stage: PART 8	Revision
Surveyed: MK/LN	Drawn: MK	Checked: BC
Approved: PH		

File Name and Directory:
 H:\CAPITAL HOUSING DESIGN TEAM\115-Ennell Court Phase 2\Drawings\03_Part 8\Ennell Court_Phase 2_Site 2_Part 8.rvt