

A1

DO NOT SCALE

File: 0086381-ATK-F1-01-DR-CE-900101.dwg
Date: Oct 29, 2025 - 4:36pm
Plotted by: GREE093

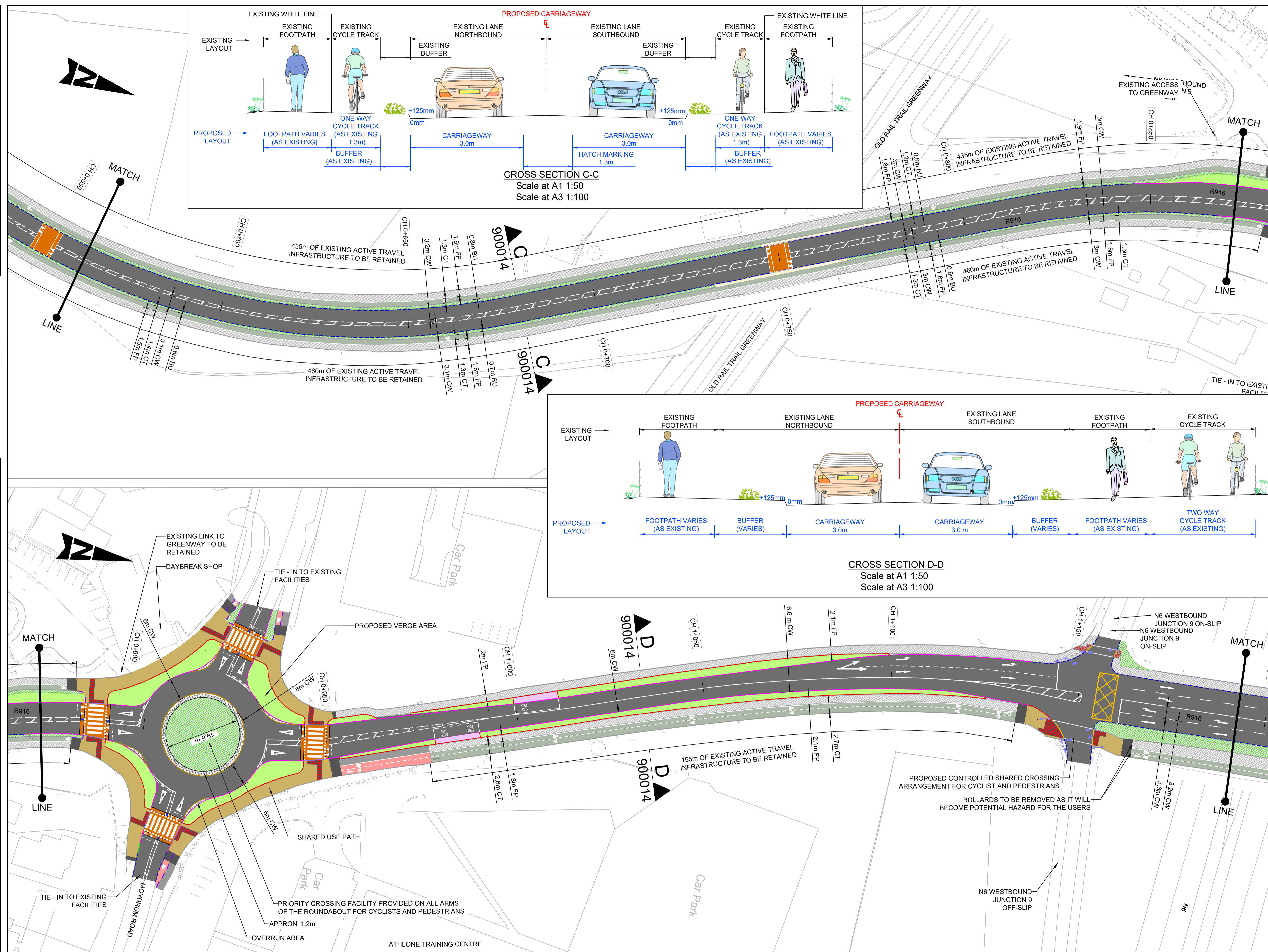

- GENERAL NOTES**
1. ALL DIMENSIONS ARE IN MILLIMETRES UNLESS NOTED OTHERWISE
 2. ONLY WRITTEN DIMENSIONS SHALL BE USED. NO DIMENSIONS SHALL BE SCALED FROM THE DRAWINGS
 3. ALL LEVELS ARE IN METRES AND ARE TO MALIN HEAD DATUM
 4. ALL COORDINATES ARE IN METRES AND ARE TO IRISH TRANSVERSE MERCATOR
 5. DRAWINGS ARE TO BE READ IN CONJUNCTION WITH THE SPECIFICATION

- LEGEND**
- CARRIAGEWAY
 - PROPOSED SEGREGATION BUFFER/ HARD STANDING
 - PROPOSED CYCLE TRACK (STEPPED)
 - PROPOSED CYCLE TRACK (FOOTWAY LEVEL)
 - PROPOSED CYCLE LANE
 - PROPOSED SHARED USE FACILITY
 - PROPOSED NEW/ UPGRADED FOOTWAY
 - PROPOSED LANDSCAPING
 - PROPOSED REFUGE/ WAITING SPACE
 - PROPOSED RAISED TABLE/ RAMP
 - PROPOSED TRAFFIC ISLAND
 - PROPOSED RAMP
 - PROPOSED BUS SHELTER
 - LAND ACQUISITION REQUIRED
 - EXISTING LANDSCAPING TO BE RETAINED
 - EXISTING FOOTWAY TO BE RETAINED
 - EXISTING CYCLE TRACK TO BE RETAINED
 - EXISTING CYCLE LANE TO BE RETAINED
 - EXISTING SEGREGATION BUFFER/ HARD STANDING TO BE RETAINED
 - PROPOSED TACTILE PAVING (CONTROLLED CROSSING - RED COLOUR)
 - PROPOSED TACTILE PAVING (UNCONTROLLED CROSSING - BUFF COLOUR)
 - PROPOSED TACTILE PAVING (CORDUROY)
 - PROPOSED TACTILE PAVING (TRAMLINE AND LADDER)
 - PROPOSED FULL HEIGHT CONCRETE KERB (UPSTAND 100/125mm)
 - PROPOSED CONCRETE KERB (UPSTAND 60mm)
 - PROPOSED FLUSH KERB (UPSTAND 0-6mm)
 - PROPOSED FLUSH KERB AT RAISED CROSSING
 - PROPOSED BEVELLED ENTRANCE KERB
 - PROPOSED KASSEL KERB
 - PROPOSED TRAPEZOIDAL DELINEATOR STRIP
 - PROPOSED EDGING KERB
 - EXISTING KERB TO BE RETAINED
 - PROPOSED BULL NOSED KERB (UPSTAND 50mm)
 - PROPOSED BOLLARD
 - PROPOSED BELISHA BEACON
 - PRIMARY TRAFFIC SIGNAL ASPECT
 - SECONDARY TRAFFIC SIGNAL ASPECT
 - PEDESTRIAN THREE ASPECT SIGNAL
 - CYCLIST THREE ASPECT SIGNAL
 - PROPOSED PEDESTRIAN PUSH BUTTON UNIT
 - PROPOSED CYCLIST PUSH BUTTON UNIT

- NOTES:**
1. ROAD WIDTH TO BE MINIMUM 6.0m WIDE UNLESS NOTED OTHERWISE.
 2. PROPOSED ONE-WAY CYCLE TRACK, TWO-WAY CYCLE TRACK TO BE MINIMUM 1.7m AND 2.3m WIDE RESPECTIVELY UNLESS NOTED OTHERWISE.
 3. PROPOSED FOOTWAY TO BE MINIMUM 1.8m WIDE UNLESS NOTED OTHERWISE.
 4. OPPORTUNITIES TO MAXIMIZE CYCLE TRACK WIDTH IS STILL UNDER INVESTIGATION.
 5. MATERIALS TO BE USED FOR LANDSCAPING/ HARD STANDING TO BE CONFIRMED AT SUBSEQUENT DESIGN STAGE.

© ORDNANCE SURVEY IRELAND LICENSE NR. AR 0082525. ORDNANCE SURVEY IRELAND & GOVERNMENT OF IRELAND
ATKINS WILL NOT BE HELD LIABLE FOR THE USE OF THIS DATA ON ANY PROJECT OTHER THAN THE PROJECT.
ATHLONE ACTIVE TRAVEL SCHEMES BUNDLE

| | | |
|------------|---|----------------------------------|
| Risk Level | X | Atkins Base Line - Low Risk |
| | | Atkins Sensitive - Medium Risk |
| | | Atkins Private - High Risk |
| | | Client Critical - Already Marked |



Rialtas na hÉireann
Government of Ireland
Tionscadal Éireann
Project Ireland
2040



Atkins House, 150-155 Ainslie Road, Business Park, Swords, Co. Dublin
Tel (+353) 01 810 8000
Fax (+353) 01 810 8001

Unit 2B, 2200 Cork Airport Business Park, Cork
Tel (+353) 021 429 0300
Fax (+353) 021 429 0360

1st Floor Technology House Parkmore Technology Park, Galway
Tel (+353) 091 786 050
Fax (+353) 091 779 830

Client: WESTMEATH COUNTY COUNCIL
Project: ATHLONE ACTIVE TRAVEL SCHEMES BUNDLE

| | | | |
|---|--|---|--------------------------------|
| Purpose: FOR PART 8 SUBMISSION | | Title: ROUTE F GENERAL ARRANGEMENT SHEET 2 of 4 | |
| Original Scale: 1:500 at A1 1:1000 at A3 | Drawn: RD Date: 28.10.25 | Checked: JT Date: 28.10.25 | Reviewed: AB Date: 28.10.25 |
| Status: A2 | Drawing Number: 0086381-ATK-F1-01-DR-CE-900101 | Authorised: ST | Rev: C01 |