

- GENERAL NOTES**
- THIS DRAWING SHOULD BE READ IN CONJUNCTION WITH ALL RELEVANT ENGINEERS AND ARCHITECTS DRAWINGS AND SPECIFICATIONS.
 - ALL LEVELS ARE IN METRES TO ORDNANCE DATUM, MAIN HEAD UNLESS NOTED OTHERWISE.
 - THE POSITION OF EXISTING SERVICES AS SHOWN ON THE DRAWING MAY NOT BE ACCURATE. THE CONTRACTOR SHALL BE FULLY RESPONSIBLE FOR LOCATING ALL EXISTING SERVICES ON THE SITE AND SHOULD CONTACT THE RESPECTIVE UTILITY PROVIDERS AND AUTHORITIES FOR THE MOST UP-TO-DATE INFORMATION BEFORE COMMENCING THE WORKS.
 - EXISTING LEVELS ARE INDICATIVE ONLY AND MUST BE CHECKED AND VERIFIED ON SITE PRIOR TO COMMENCEMENT.
 - PROPOSED MANHOLE COVER LEVELS ARE APPROXIMATE AND SHOULD BE ADJUSTED TO SUIT LOCAL FINISHES.
 - ALL SURFACE WATER DRAINAGE INFRASTRUCTURE SHALL BE CONSTRUCTED IN ACCORDANCE WITH LOCAL AUTHORITY REQUIREMENTS.
 - LOCKABLE TYPE GULLY TRAPS TO BE USED ON ALL SURFACE WATER DRAINS.
 - GULLY POSITIONS ARE APPROXIMATE ONLY AND SHOULD BE LOCATED AT LOW POINTS.
 - REFER TO ARCHITECTS' DRAWINGS FOR ALL ROOF DRAINAGE, STRIP DRAINS AND GULLY TRAPS BENEATH DOWNPIPES.
 - WHERE IT IS NOT POSSIBLE TO ACHIEVE MINIMUM COVER, PIPES SHOULD BE REDDED AND SURROUNDED IN CONCRETE 150mm THICK CLASS E IN ACCORDANCE WITH TI STANDARD CONSTRUCTION DETAIL CC-SCD-05521.
 - ALL WASTEWATER DRAINAGE INFRASTRUCTURE SHALL BE CONSTRUCTED IN ACCORDANCE WITH IRISH WATER STANDARDS. REFER TO IRISH WATER PUBLICATIONS 'WATER INFRASTRUCTURE STANDARD DETAILS - IW-CDS-5020-01' AND 'CODE OF PRACTICE FOR WASTEWATER INFRASTRUCTURE - IW-CDS-5020-03'.
 - HYDRANTS TO BE ACCORDANCE WITH IRISH WATER STANDARD DETAILS STD-W-16 TO STD-W-19.
 - THRUST BLOCK ARRANGEMENTS SHALL COMPLY WITH IRISH WATER STANDARD DETAILS STD-W-19.
 - REFER TO MECHANICAL AND ELECTRICAL ENGINEERS' DRAWINGS FOR INTERNAL DRAINAGE AND DETAILS OF SOIL AND VENT PIPES LEADING TO WASTEWATER DRAINAGE AIS.
 - ALL WATER INFRASTRUCTURE SHALL BE CONSTRUCTED IN ACCORDANCE WITH IRISH WATER STANDARDS. REFER TO IRISH WATER PUBLICATIONS 'WATER INFRASTRUCTURE STANDARD DETAILS - IW-CDS-5020-01' AND 'CODE OF PRACTICE FOR WATER INFRASTRUCTURE - IW-CDS-5020-03'.
 - ALL PLANTING & TREES TO COMPLY WITH SEPERATION DISTANCES AS PER IRISH WATER STANDARD DETAILS FOR WASTEWATER, STD-W-06 AND STD-W-06A AND FOR WATER, STD-W-12 AND STD-W-12A.
 - A METHOD STATEMENT SHALL BE SUBMITTED FOR APPROVAL PRIOR TO INSTALLATION AND TESTING.
 - ALL PIPE DIAMETERS INDICATED ARE INNER DIAMETER.

- CIVIL SERVICES LEGEND**
- PROPOSED 125mm WALL SURFACE WATER PIPES
 - EXISTING SURFACE WATER PIPES
 - PROPOSED PVC FOUL SEWER PIPES
 - EXISTING FOUL SEWER PIPES
 - PROPOSED PVC COMBINED SEWER PIPES
 - EXISTING COMBINED SEWER PIPES
 - PROPOSED 150mm PE WATERMAIN
 - EXISTING WATERMAIN
 - BOUNDARY LINE
 - DENOTES 6m & 4m SEPARATION DISTANCE OF WATER HYDRANT
 - PROPOSED SURFACE WATER MANHOLE
 - PROPOSED FOUL SEWER MANHOLE
 - EXISTING MANHOLE
 - GULLY
 - FOUL SEWER INSPECTION CHAMBER
 - STORM WATER INSPECTION CHAMBER
 - WATERMAIN BOUNDARY BOX
 - PROPOSED MANHOLE SUPPLY
 - PROPOSED AJ CHAMBER
 - COVER LEVEL
 - INVERT LEVEL
 - ANCHOR/THRUST BLOCK
 - SLUICE VALVE
 - SCOUR VALVE
 - HYDRANT
 - DRY RISING MAIN
 - AIR VALVE
 - WATER METER
 - DROP MANHOLE

- DECOMMISSIONING LEGEND**
- EXISTING FOUL SEWER PIPES
- SERVICES BEING REMOVED TO BE GRUBBED UP AND CAPPED AT SITE BOUNDARY. DISUSED MANHOLES AND CHAMBERS TO BE EXCAVATED AND BACKFILLED WITH IMPORTED FILL BELOW PAVED AREAS AND LEAN MIX BELOW ALL FUTURE BUILDINGS WITH THE EXCEPTION OF SERVICES IN THE CANAL EMBANKMENT WHICH ARE TO BE LEFT IN-SITU AND CAPPED AT SITE BOUNDARY ONLY.

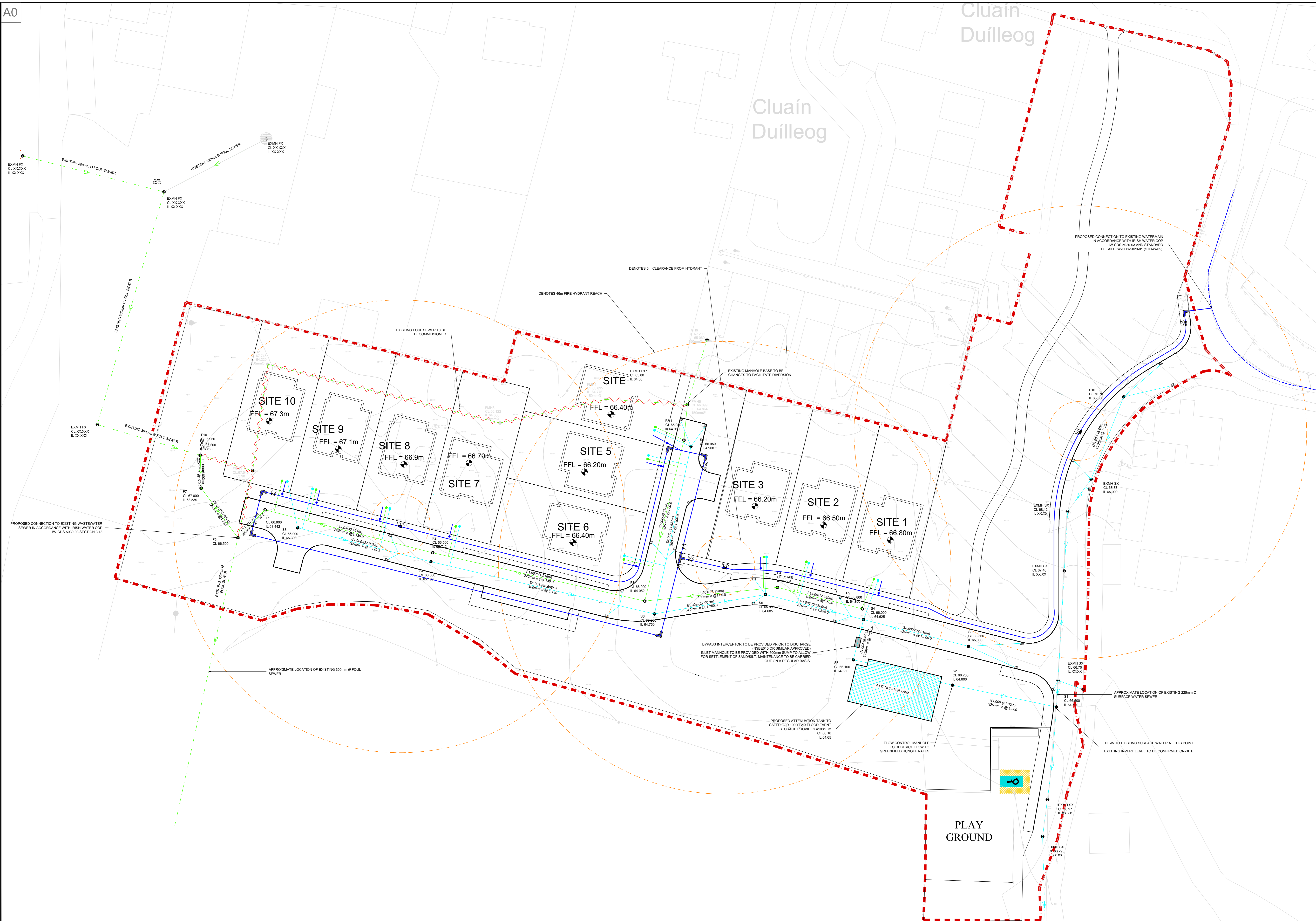

INFORMATION

© ORS
This drawing and any design herein is the copyright of the Consultants and must not be reproduced without their written consent. All drawings remain the property of the Consultants.
Figured dimension only to be taken from this drawing. All dimensions to be checked on site. Consultants to be informed immediately of any discrepancies before work proceeds.

REV NO.	DATE	REVISION NOTE	DWN BY	CKD BY
P01	23/01/2024	ISSUED FOR PLANNING	PMC	MH

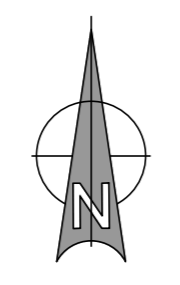

CLIENT:	WESTMEATH COUNTY COUNCIL
PROJECT:	PROPOSED SERVICED SITES KILLENBOYLEGAN, MOATE, CO. WESTMEATH
TITLE:	CIVIL SERVICES LAYOUT PLAN
DRAWN:	PMC
CHECKED:	RD
APPROVED:	MH
JOB NO:	230894
DATE:	OCT. 2023
SCALE:	1:250
DRAWING NO:	230894-ORS-Z2-00-DR-CE-400
REV:	P01

ORS

Mullingar | Dublin | Galway | Donegal | Cork
T: +353 1 5242060 | www.ors.ie | info@ors.ie
ISO 9001:2015 QUALITY ASSURED COMPANY