

Refer to site plan for orientation

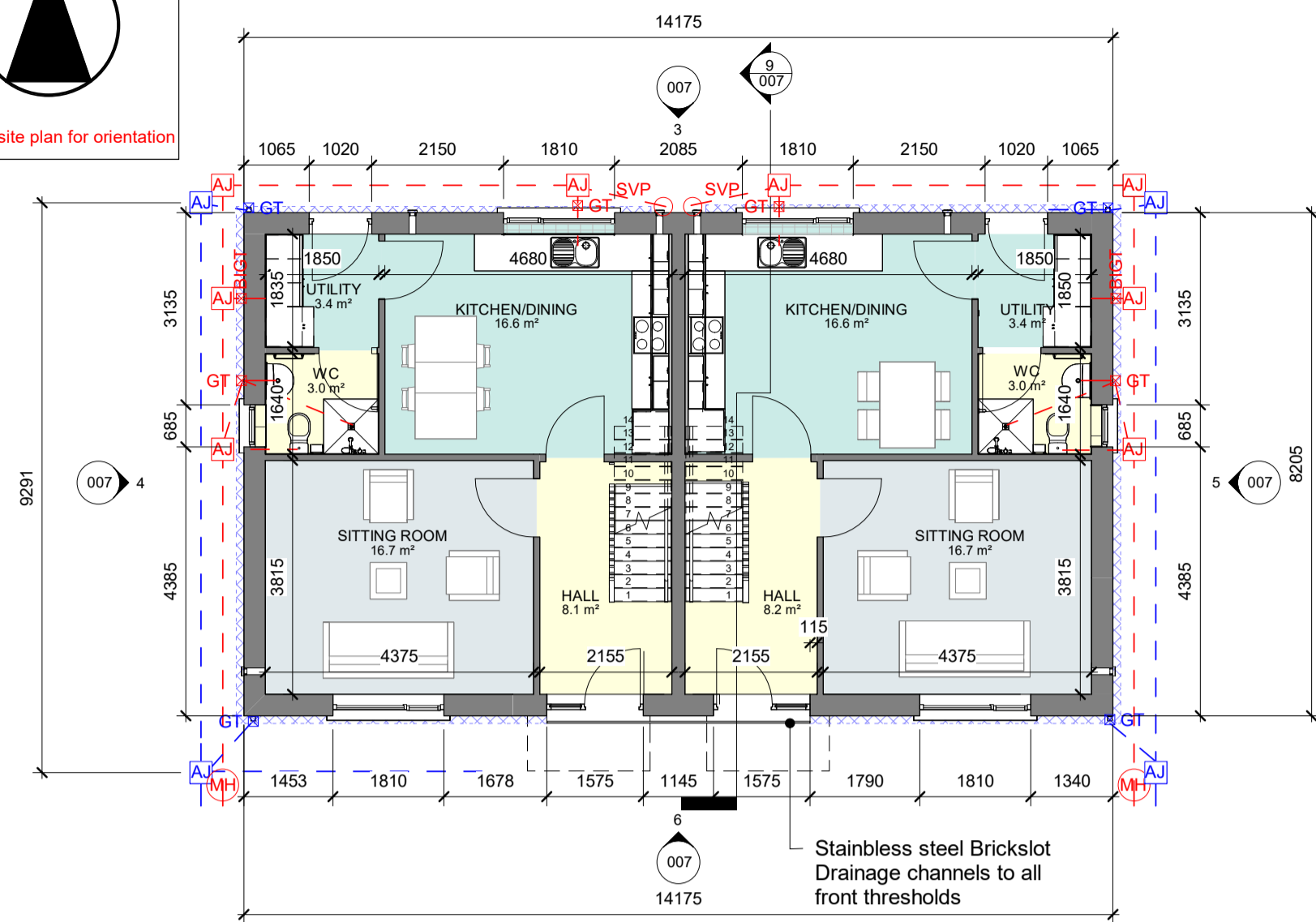

1 Ground Floor Plan
1: 100



6 Front Elevation
1: 100

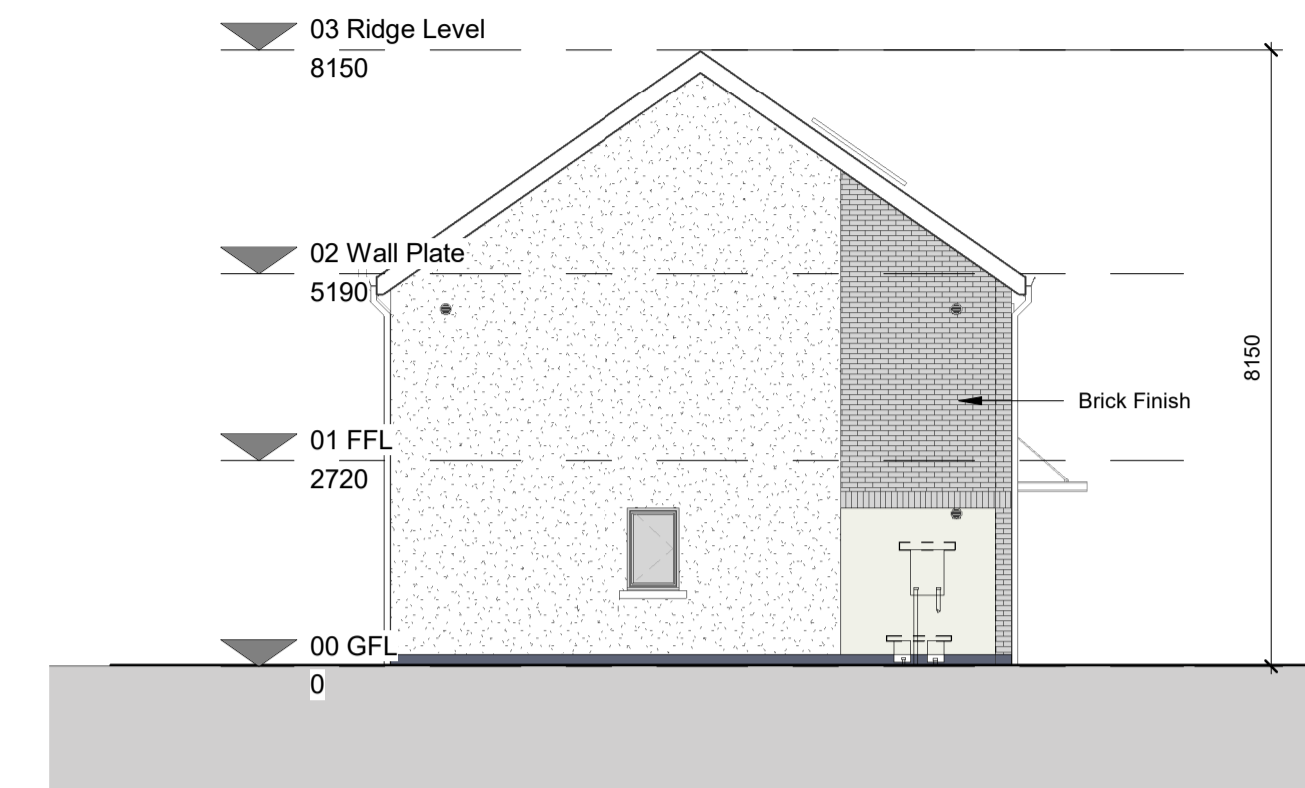

4 Side Elevation 2
1: 100

DRAINAGE LEGEND

- FOUL WATER MANHOLE TO IRISH WATER STANDARDS
- FOUL WATER AJ
- FOUL WATER SOIL VENT PIPE
- FOUL WATER GULLY TRAP
- FOUL DRAINAGE PIPE RUN
- RAIN WATER DOWN PIPE
- SURFACE WATER AJ
- SURFACE WATER DOWNPIPE GULLY INTERGRATED INTO DRAINAGE CHANNEL WHERE REQUIRED
- SURFACE WATER DRAINAGE PIPE RUN
- LEVEL THRESHOLD DRAINAGE CHANNEL

EXTERNAL FINISHES LEGEND

- Selected Finishing Brick_Type 1
- Smooth Acrylic Plaster Finish Colour 2- Pebble Grey
- Smooth Acrylic Render Finish to rear and side elevations with anti fungal coating as per spec.
- Smooth Acrylic Plaster Finish Colour 1- Navy

NO UPVC FINISHES SHALL BE ACCEPTABLE
PLANNING - SECTION 179A

Revision Schedule

Rev No.	Rev Description	Rev Date	Issued by	Issued to

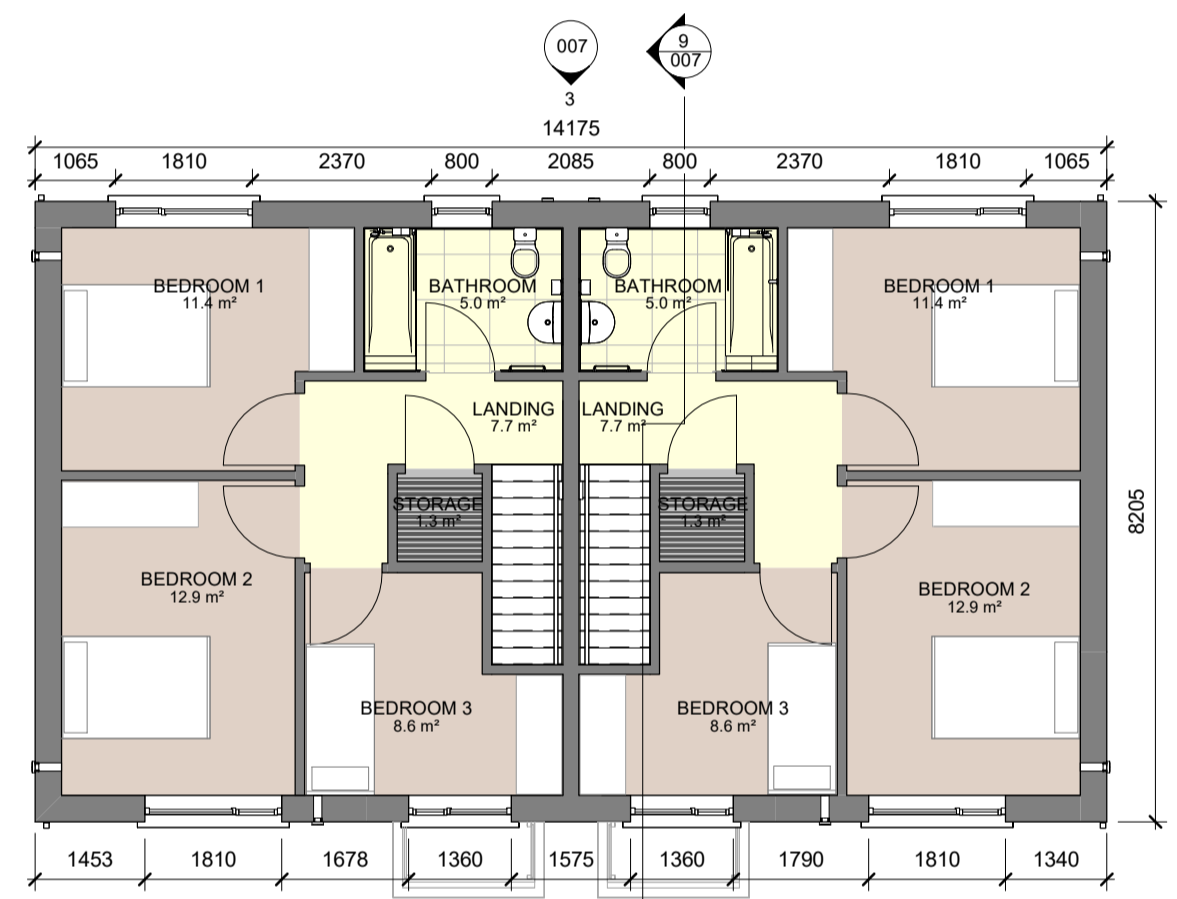

2 First Floor Plan
1: 100



3 Rear Elevation
1: 100

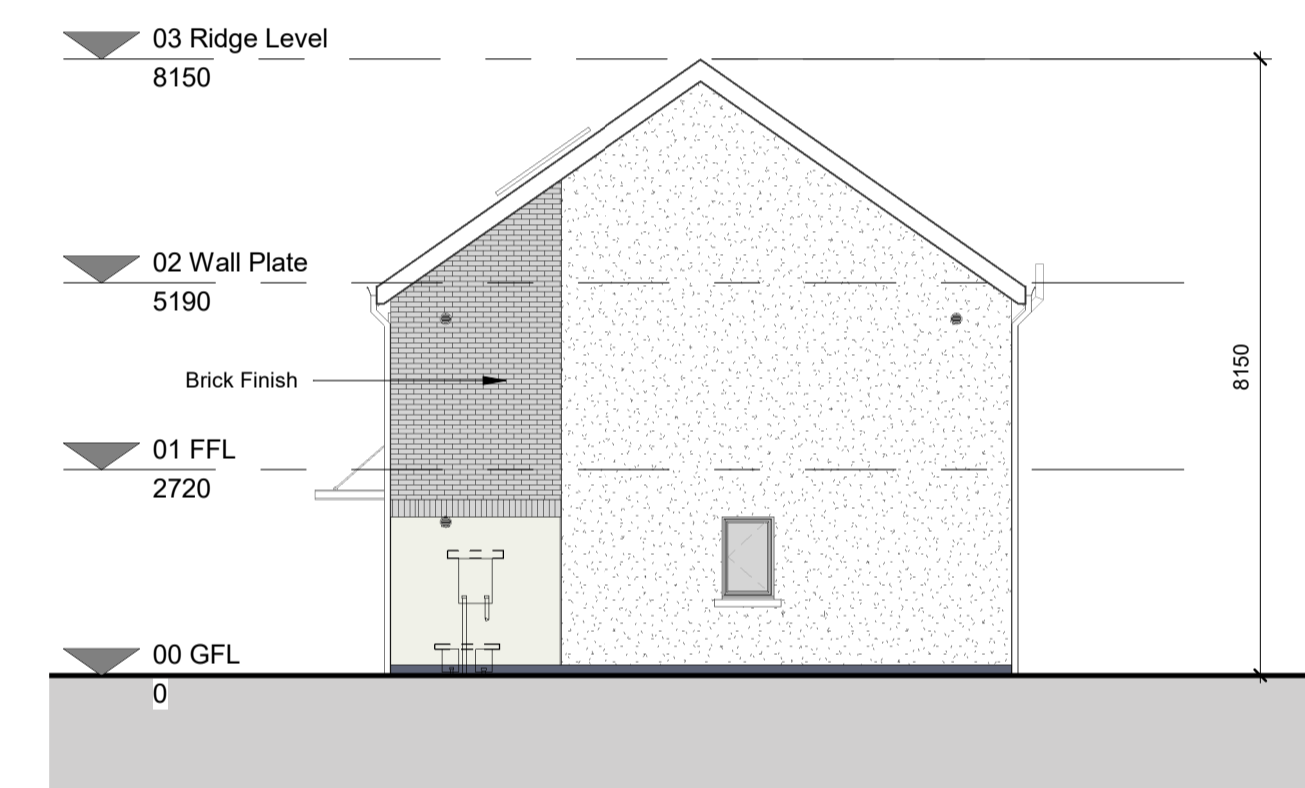

5 Side Elevation 1
1: 100

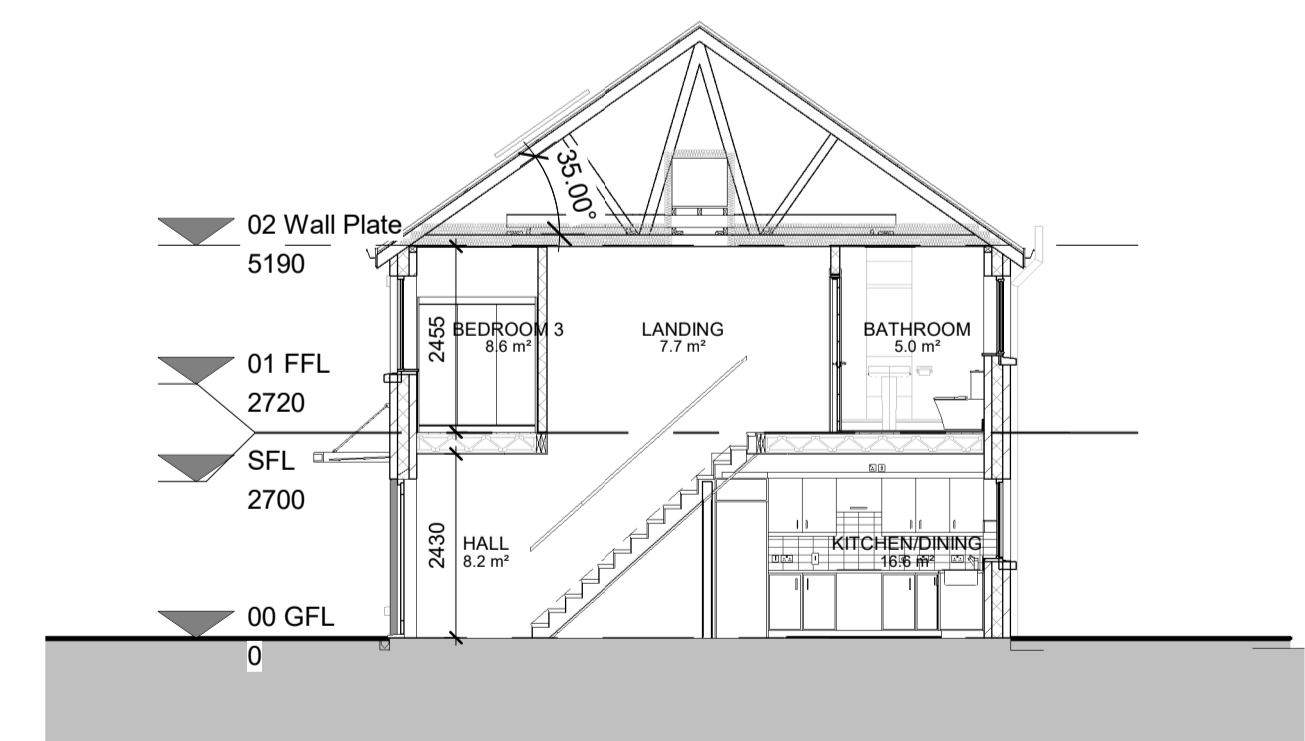
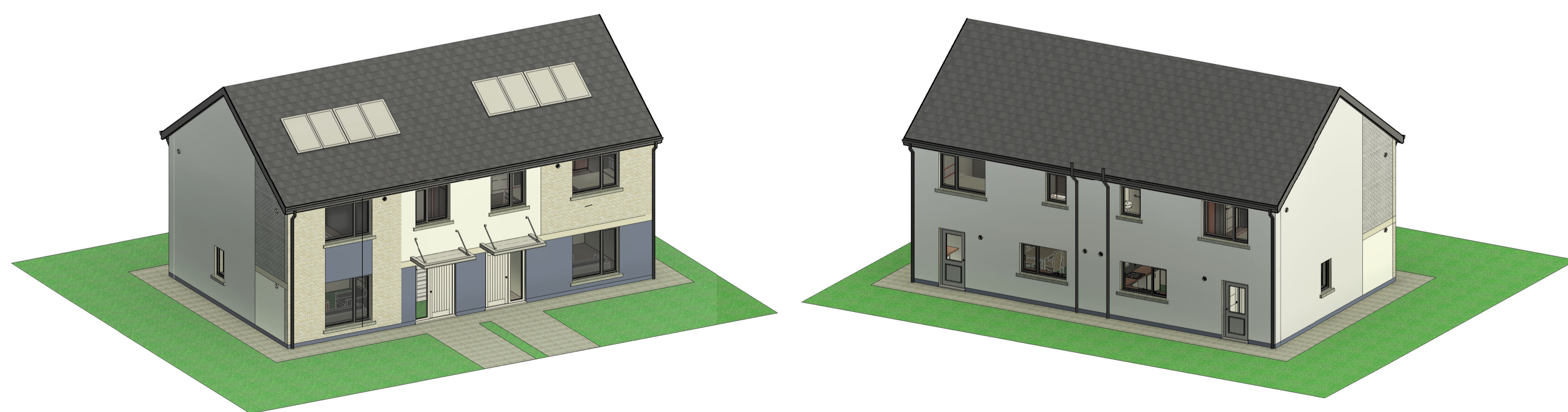

9 Section 1
1: 100

TABLE - SPACE PROVISION AND ROOM SIZES FOR TYPICAL DWELLINGS

House Type	TARGET GROSS FLOOR AREA (m²)
3 BED, 5P HOUSE (2 STOREY)	92m²
FLOOR AREA	99.52m² (92m² + 10% = 101.2m²)

House designed in accordance with Design Manual for Quality Housing DOEHLG 2022

Housing for All

A new Housing Plan for Ireland



WESTMEATH HOUSING DESIGN TEAM
CIVIC CENTRE, CHURCH ST, ATHLONE, N37 P2T5
Phone: 09064 42100
Web: www.westmeathcoco.ie

PROJECT:
Construction of 12 Houses at The Green Boreen Bradach Bundaire Kinnegad

TITLE:
3 Bedroom Semi Detached House

Scale: As indicated @ A1	Datum: MALIN	Date: 06/11/23
Drawing No: 129_03_007	Stage: PLANNING	Revision:
Surveved AC & CH	Drawn AC	Checked AF
Approved		

File Name and Directory:
H:\CAPITAL HOUSING DESIGN TEAM\1-Capital Schemes\129 Bun Dara Legacy\Drawings\111 Planning\Drawing\111_Model.rvt